



2011 Technical Manual

!WARNING!

Removing the DRAW STOP POST could result in bodily injury and will void any and all warranties.

Tuning and Technical information for the HUNTER™, PULSE™, PURE™ and TOUR™ compound bows featuring the Patent Pending Two Track EFX, ESX and TOUR Cam Systems.

2011 HUNTER

A-A 31 3/4" +/- .125"
String 54 1/2"

Brace 7 1/2" +/- .125"
Cable 36 3/8"

ESX Cam (Modular)	Cam setting @ Brace from .160 hole to inside of limb	Speed Rating #70 350 grain arrow
#1 – 30"	.860" gap	320-323 fps
#2 – 29.5"	.880" gap	315-318 fps
#3 – 29"	.885" gap	310-313 fps
#4 – 28.5"	.835" gap	305-308 fps
#5 – 28"	.785" gap	300-303 fps
#6 – 27.5"	.740" gap	292-295 fps
#7 – 27"	.700" gap	286-289 fps

Deduct 2 fps from rating for #60 peak weight

Limb Deflection

90
 105
 123
 220
 250

Poundage of Bow

80
 70
 60
 50
 40

Pivots

Tall
 Tall
 Tall
 Tall
 Tall

Spacers

.065" string side

.070" +/- .005" cable side

Centershot

3/4" - 7/8"

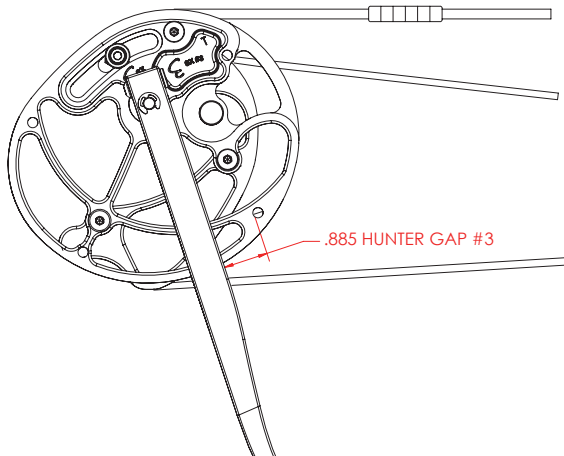

2011 HUNTER w/TOUR Cams

A-A 32 1/4" +/- .125"
String 52 1/2"

Brace 7 1/2" +/- .125"
Cable 36 3/4"

TOUR Cam TSX Mod	Cam setting @ Brace from .160 hole to inside of limb	Speed Rating #70 350 grain arrow
#8 – 26.5"	1.100" gap	282-285 fps
#9 – 26"	1.085" gap	276-279 fps
#10 – 25.5"	1.080" gap	272-275 fps
#11– 25"	1.070" gap	266-269 fps

Deduct 2 fps from rating for #60 peak weight

Limb Deflection	Poundage of Bow	Pivots
82	80	Tall
90	70	Tall
105	60	Tall
123	50	Tall
220	40	Tall

Spacers .065" string side 070" +/- .005" cable side

Centershot 3/4" - 7/8"

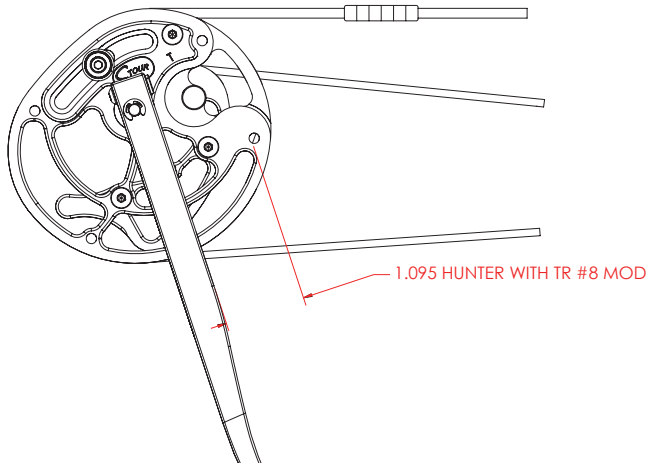

2011 PULSE

A-A 34 1/8" +/- .125"
String 58 7/16"

Brace 6" +/- .125"
Cable 39"

EFX Cam (Modular) Cam setting @ Brace from .160 hole to **inside** of limb **Speed Rating** #70 350 grain arrow

#1 – 30"	.660" gap	340-343 fps
#2 – 29.5"	.600" gap	334-337 fps
#3 – 29"	.530" gap	329-332 fps
#4 – 28.5"	.525" gap	324-327 fps
#5 – 28"	.540" gap	319-322 fps
#6 – 27.5"	.480" gap	314-317 fps
#7 – 27"	.450" gap	309-312 fps
#8 – 26.5"	.410" gap	304-307 fps
#9 – 26"	.380" gap	299-302 fps

Deduct 2-3 fps from rating for #60 peak weight

Limb Deflection

105
 123
 210

Poundage of Bow

70
 60
 50

Pivots

Tall
 Tall
 Tall

Spacers

.065" string side

.070"+/- .005" cable side

Centershot

3/4" - 7/8"

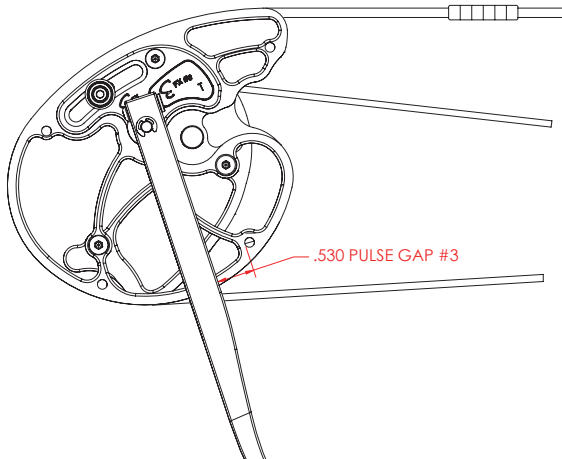

2011 PURE

A-A 36" +/- .125"
String 60 3/8"

Brace 7" +/- .125"
Cable 40 3/8"

EFX Cam (Modular) Cam setting @ Brace from .160 hole to **inside** of limb **Speed Rating** #70 350 grain arrow

#1 – 31.5"	.660" gap	339-343 fps
#2 – 31"	.525" gap	336-340 fps
#3 – 30.5"	.570" gap	328-333 fps
#4 – 30"	.525" gap	326-330 fps
#5 – 29.5"	.540" gap	318-323 fps
#6 – 29"	.460" gap	316-320 fps
#7 – 28.5"	.435" gap	308-313 fps
#8 – 28"	.400" gap	306-310 fps
#9 – 27.5"	.350" gap	298-303 fps

Deduct 2-3 fps from rating for #60 peak weight

Limb Deflection

105
 114
 135
 220

Poundage of Bow

80
 70
 60
 50

Pivots

Tall
 Tall
 Tall
 Tall

Spacers

.065" string side

.070" +/- .005" cable side

Centershot

3/4" - 7/8"

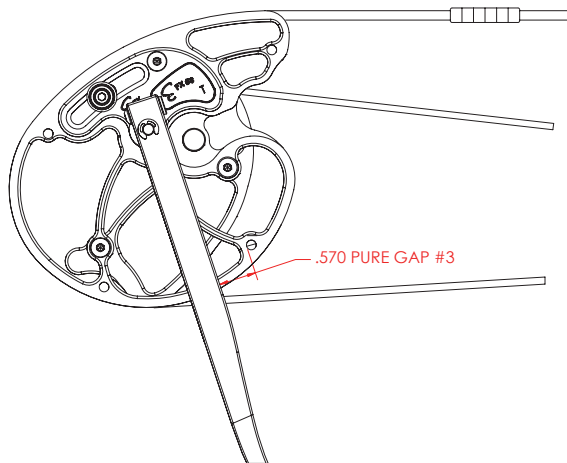

2011 TOUR

A-A 38" +/- .125"
String 58 5/8"

Brace 7 7/8" +/- .125"
Cable 41 15/16"

TOUR Cam Cam setting @ Brace from **Speed Rating**
TR Mod .160 hole to **inside** of limb #70 350 grain arrow

#5 – 30"	1.23" gap	305-308 fps
#6 – 29.5"	1.20" gap	300-303 fps
#7 – 29"	1.21" gap	295-298 fps
#8 – 28.5"	1.215" gap	290-293 fps
#9 – 28"	1.185" gap	285-288 fps
#10 – 27.5"	1.160" gap	280-283 fps
#11 – 27"	1.130" gap	275-278 fps

Deduct 2-3 fps from rating for #60 peak weight

Limb Deflection	Poundage of Bow	Pivots
105	70	Tall
123	60	Tall
210	50	Tall

Spacers .065" string side 070" +/- .005" cable side

Centershot 3/4" - 7/8"

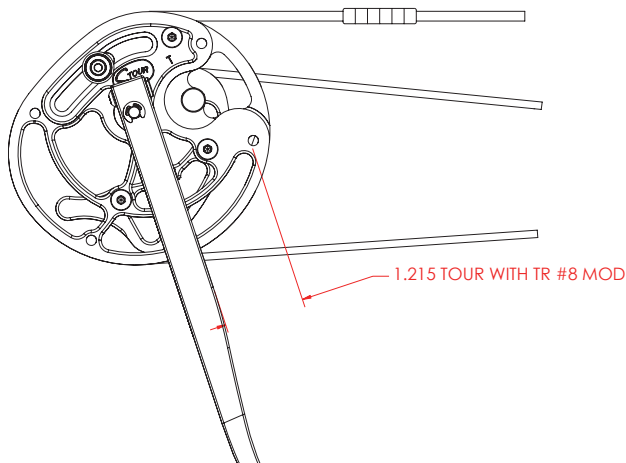

2011 TOUR w/ ESX Cams

A-A 38" +/- .125"
String 60 5/8"

Brace 7 7/8" +/- .125"
Cable 42 3/8"

TOUR Cam TRS Mod	Cam setting @ Brace from .160 hole to inside of limb	Speed Rating #70 350 grain arrow
#1 – 32"	.390" gap	325-328 fps
#2 – 31.5"	.375" gap	320-323 fps
#3 – 31"	.350" gap	315-318 fps
#4 – 30.5"	.390" gap	310-313 fps

Deduct 2-3 fps from rating for #60 peak weight

Limb Deflection

105
123
210

Poundage of Bow

70
60
50

Pivots

Tall
Tall
Tall

Spacers

.065" string side

070" +/- .005" cable side

Centershot

3/4" - 7/8"

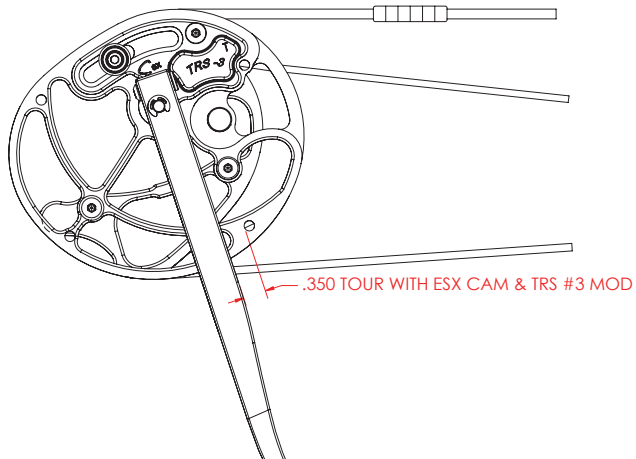



The Elite Promise

Elite Archery announces a groundbreaking new Guarantee on its bows as well as positive changes to its Limited Lifetime Warranty. Coupled together, this Elite Promise gives hunters and archers the peace of mind knowing Elite Archery stands behind its products, its dealers, and its customers.

Elite Archery Limited Lifetime Warranty

Elite Archery stands behind the workmanship and overall quality of its bows through a Limited Lifetime Warranty. This Limited Lifetime Warranty is fully transferable and is valid no matter where the bow was purchased (new or used). This warranty covers the riser, pocket, limbs and eccentrics against defects in material and workmanship for the lifetime of the bow. The Limited Lifetime Warranty covers all bows manufactured by Elite Archery in the past and present.

The Elite Archery Limited Lifetime Warranty does not cover strings, cables, decoration and overall finish of the bow. Alterations or modifications to the bow by the consumer may void this Limited Lifetime Warranty. The Limited Lifetime Warranty does not cover misuse or abuse of the bow such as dry-firing, dropping, intentional or unintentional damage, etc. Elite Archery reserves the right to deny warranty coverage in the event that misuse is observed.

Elite Archery retains the right to replace components with equivalent components that may be of different design or decoration. Elite Archery may also request to visually inspect failed components prior to issuing parts and/or service.

There are no other warranties expressed or implied binding Elite Archery, Certified Elite Dealers and Certified Elite Distributors (International).

Elite Hunt Guarantee

Elite Archery believes that our customers are top priority and we want our customers to be 100% confident in their bows. Elite Archery is comprised of dedicated and passionate bow hunters – for this reason we offer a unique guarantee for our hunting customers.

It happens. You are on the hunt of a lifetime and you accidentally touch your broadhead to your string. You are taking your one-week of vacation to hunt with your friends and your buddy dry-fires your bow. If there isn't a bow shop within driving distance, your hunt is over – but not if you're shooting an Elite bow. No matter where you are or what happened to your bow, Elite will send a bow to you at no charge the very next day so that you can finish your hunt. This bow is on loan from Elite Archery and not intended to replace your damaged bow. The loaner bow will arrive with the customers requested draw weight and length, with a rest, sight and peep installed. The bow will be tuned and ready to shoot. It will only need to be sighted in with the customer's arrows.

If something happens to your bow while on your hunt, please call us at 877-503-5483 and ask for the warranty department. The bows must be returned to us in the condition that they were shipped with all accessories. The loaner bow must be sent using a shipping company that provides package tracking. Our goal is to make sure you can finish your hunt, no matter where you are, no matter what happened.

Adjusting the Draw Weight

Before making any adjustments to the limb bolts, the four pocket set screws need to be loosened about one full turn. After adjusting the limb bolts to the desired weight, make sure and tighten the four pocket set screws. **WARNING: DO NOT TURN THE LIMB BOLTS OUT MORE THAN THE RECOMMENDED TWO (2) TURNS!** Doing so could damage the bow, cause limbs to break out of their pockets and result in bodily injury. It will also void your Elite warranty

Cam Adjustment and Tuning

2011 Elite Archery bows use a modular based cam system. All Elite bows are set to peak performance from the factory. See cam adjustment basics chart for more information.

NOTE: Draw stop setting adjustments allow fine tuning to achieve individual draw length requirements, however adjusting the draw length will affect the let-off and the valley at the same time. Achieving an exact let-off at a specific draw length will require some trial and error of minor modifications and/or the use of a draw board and digital scale. See your local Elite dealer or pro shop for assistance.

STRING, CABLES AND TUNING FOR ALL ELITE BOWS...

- Elite recommends that you cycle the bow 100-125 times to settle the string and cables into the grooves. To adjust your peep sight, simply twist the string from the bottom in ½ turn increments until the peep sight aligns. In some cases, this may need to be repeated after cycling and an additional 150-200 shots.
- We recommend waxing the string often. To wax the string, apply wax liberally to the entire length of the string. Rub briskly with fingers until the string appears slick. Remove excess wax with a clean towel or cloth. Waxing every other time you shoot will lengthen the life of your string and cable sets.
- Only replace your string and cables using 24 stands of BCY 452X. Replacing with other material or reducing the strands will void your warranty.
- When setting the center shot on 2011 Elite bows, measure from the inside of the riser from the berger hole to the center of the arrow. This measurement should be 3/4" - 7/8".
- We recommend shooting arrows that weigh no less than 5 grains per pound of draw weight. Using arrows with less than 5 grains per pound will void any and all warranties and could cause bodily harm to yourself or damage your bow.

MODULAR CAM CHANGE INSTRUCTIONS

These instructions are intended to be performed on a bow with no accessories installed. A bow press designed for use on a parallel limb bow is recommended. A draw board will be helpful for resetting the draw stop locations after the mods have been changed.

1. Properly prepare the bow press to work on a parallel limb bow.
2. Place bow in press and deflect the limbs enough to relax the string and cables.
3. Work on one end of the bow at a time. Note the location of where each of the string and cable loops attach to their posts in order to avoid incorrect installation once the mod has been changed.
4. Remove cables from their post. Secure them in a manner which will prevent twists from being lost or added.
5. Using a size T10 Torx driver, remove the three screws that secure the mod to the cam.
6. Using a size 7/64" allen wrench, remove the draw stop.
7. Remove the mod from the cam and install the desired size mod.
8. Using a size 7/64" allen wrench, install the draw stop. Be sure not to over tighten as this could cause the damage to the screw.
9. Using a size T10 Torx driver, install the three screws that secure the mod to the cam. Be sure not to over tighten as this could cause damage to the screw, mod or cam.
10. Install the cables back onto their correct posts.
11. Repeat these steps on the opposite end of the bow.
12. Be sure to verify the string and cables are in their appropriate tracks. Carefully relax the limbs and remove the bow from the press.
13. Set the draw stop locations in order to achieve the desired draw length and holding weight.

2011 Modular Cam Exploded Views

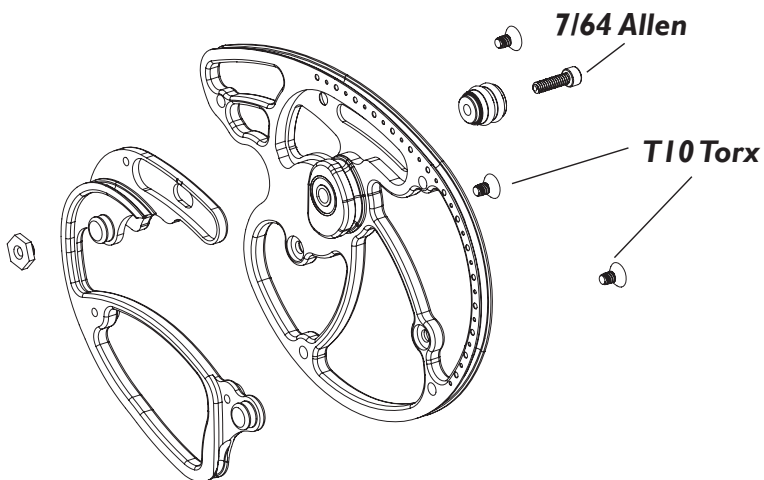

Cable Side View

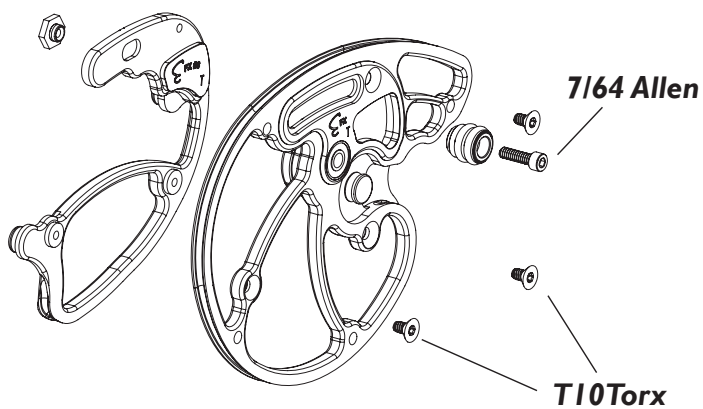

String Side View



ELITE ARCHERY CAM ADJUSTMENT BASICS

ADJUSTMENT RESULTS						
Adjustment	Cam Rotation	Draw Length	Draw Weight	Valley / Letoff	ATA	Brace Height
Twisting Cables	Advance	Increase	Increase	Slightly Increase	Decrease	Slightly Increase
Untwisting Cables	Retard	Decrease	Decrease	Slightly Decrease	Increase	Slightly Decrease
Twisting String	Retard	Decrease	Decrease	Slightly Decrease	Slightly Decrease	Slightly Increase
Untwisting String	Advance	Increase	Increase	Slightly Increase	Slightly Increase	Slightly Decrease
Move In Draw Stops	Slightly Retard	Slightly Decrease	—————	Lengthen Valley, Increase Letoff	—————	—————
Move Out Draw Stops	Slightly Advance	Slightly Increase	—————	Shorten Valley, Increase Letoff	—————	—————

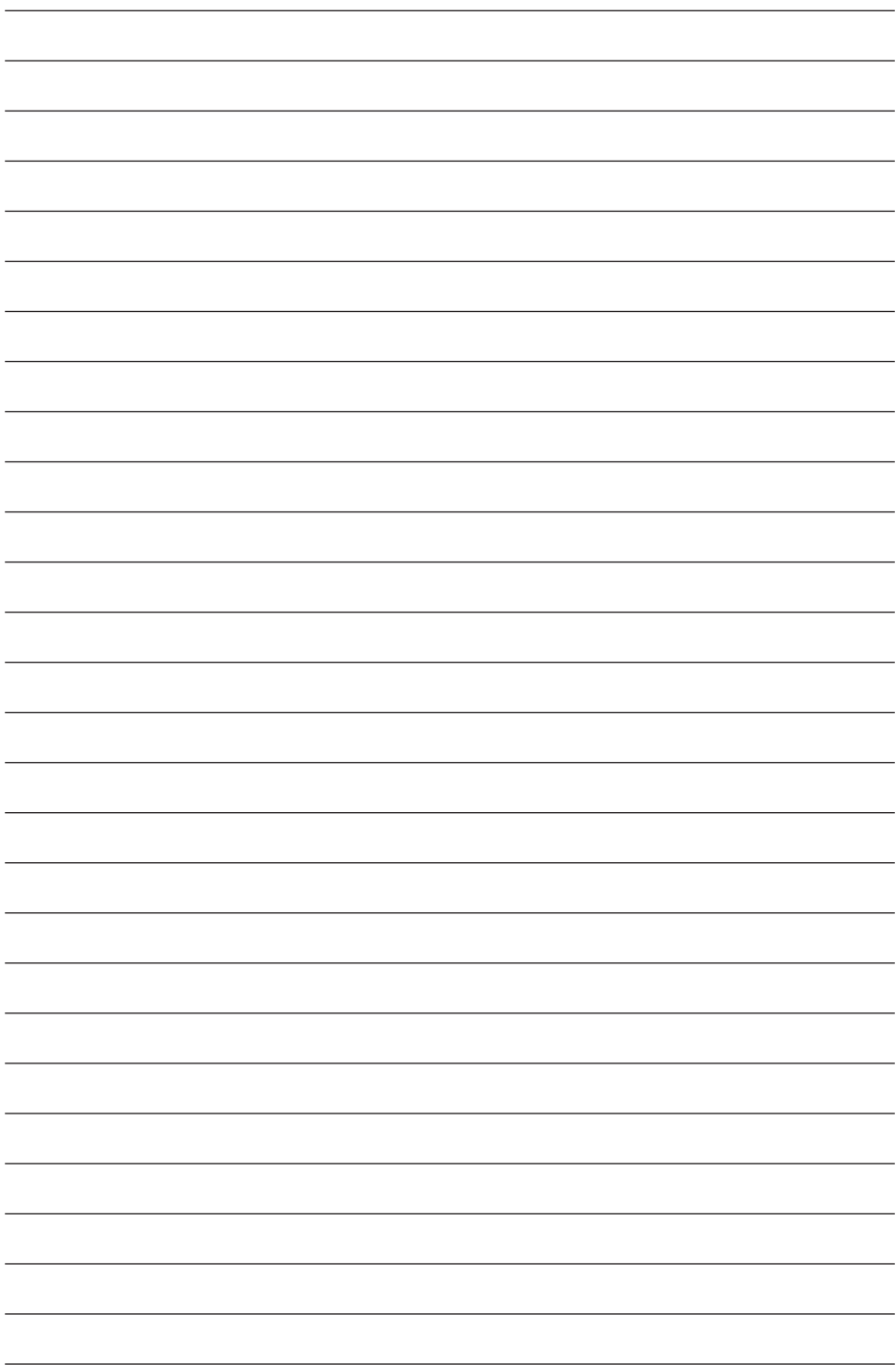

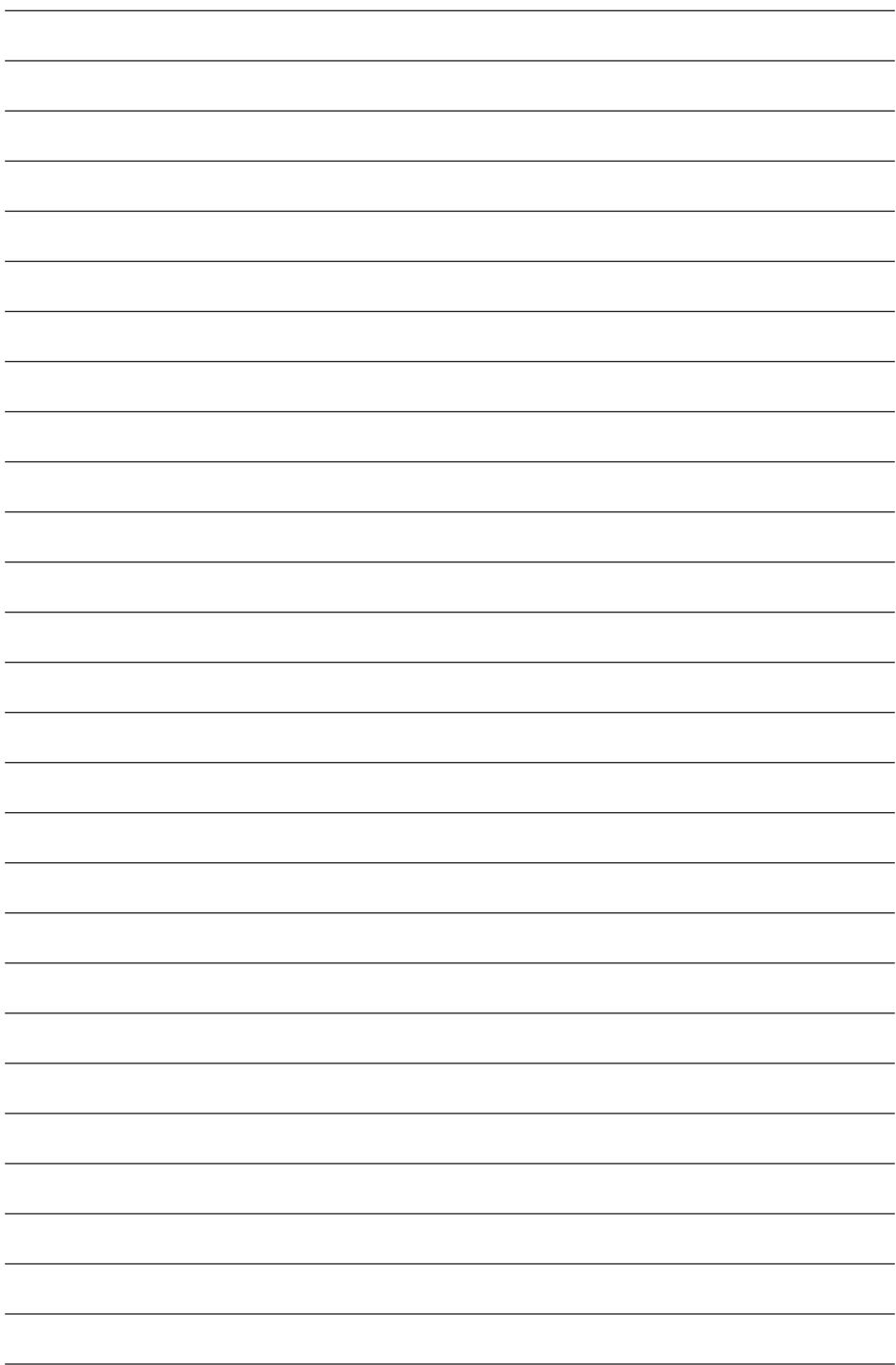

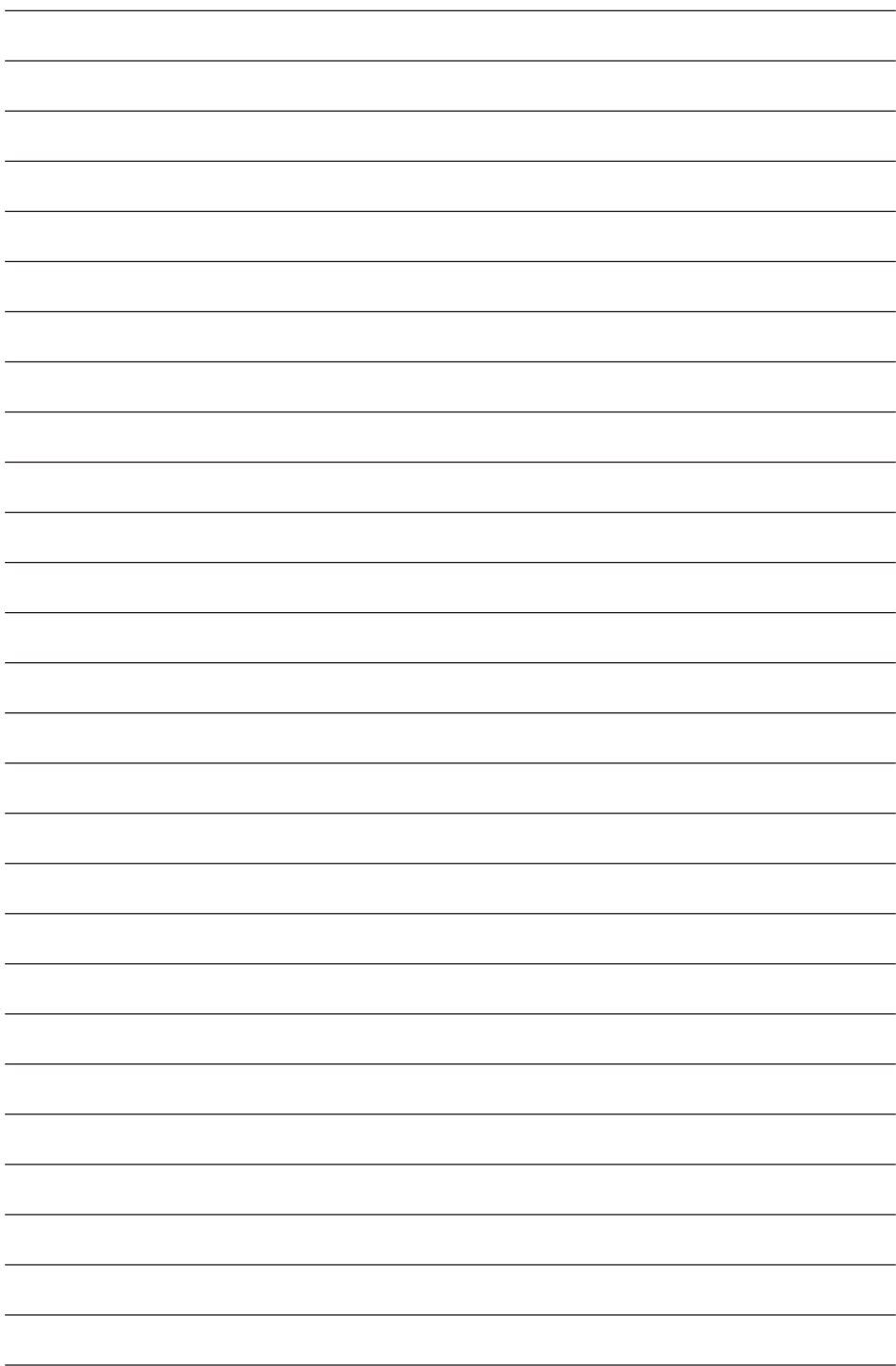



For more technical information visit www.elitearchery.com

235 Middle Rd. Henrietta, NY 14467 (877) 503-5483